

imageRUNNER ADVANCE DX 4700 Series

Print up to 51 ppm (BW)

Scan up to 270 (300 dpi) (BW/color, duplex)

Print up to 11" × 17"

6,350-sheet maximum paper capacity

Canon's comprehensive portfolio of imageRUNNER ADVANCE multifunction printers and integrated solutions can help **simplify** the end user experience and management of technology; better **control** sensitive information and print-related costs; and help ensure that technology investments proactively **evolve** with changing needs.

Black-and-white
Mid-volume
Multifunction



WORKFLOW EFFICIENCY

- 10.1" intuitive touchscreen with smartphone-like usability.
- A unique, customized experience tailored to individual preferences using My ADVANCE.
- Supports mobile solutions and integration with many popular cloud services like Google Drive.¹
- Scan and convert documents to searchable digital files in a variety of file formats.
- Integration with Canon and various third-party software with embedded application platform.
- Hot Folders allow users to drag and drop a file into a hot folder, and automatically print with predefined settings such as number of copies and finishing requirements.



SECURITY

- Advanced standard security feature set to help safeguard sensitive information and assist in regulatory compliance.
- Integrates with existing, third-party SIEM* systems to help provide real-time, comprehensive insights into potential threats to the network and printers.
- Technology to verify that the device boot process, firmware, and applications initialize without alteration at startup. McAfee Embedded Control² utilizes a whitelist to protect against malware and tampering of firmware and applications.
- Security policy settings can be controlled with a dedicated password, configured from a central location, and exported to other supported devices.
- Control access to the device and specific features, using a host of flexible authentication methods—PIN code, user name/password, or card access.³



QUALITY AND RELIABILITY

- Canon's signature reliability and engine technologies help keep productivity high and minimize the impact on support resources.
- Outstanding imaging technologies and toner allow for crisp text and consistent images in rich black-and-white tones.
- Designed to achieve maximum uptime with status notifications to help keep supplies replenished and intuitive maintenance videos for consumables replacement.
- imageRUNNER ADVANCE DX models have received many awards and recognition from leading industry analysts, often referencing strong reliability.



DEVICE AND FLEET MANAGEMENT

- Designed for quick, easy deployment.
- Remote diagnostics and parts life management for proactive maintenance and rapid fixes.
- Easy and intuitive to monitor device status and consumable levels, turn off devices remotely, observe meter readings, manage settings, and implement security policies.
- Common firmware and regular updates with Unified Firmware Platform (UFP) for continuous improvements and consistency across a fleet.



COST MANAGEMENT

- Track and assess print, copy, scan, and fax usage and allocate costs to departments or projects.
- Apply print policies and restrict usage by user to help reduce unnecessary printing and contribute to cost efficiency.
- Standard cloud-based solution provides a centralized dashboard with up-to-the-minute insights into printer activity.
- Upgrade to uniFLOW server or cloud-based solutions for full accounting and reporting for compatible Canon and third-party devices, pull printing, job routing, and powerful scan workflows.



SUSTAINABILITY

- A combination of fusing technologies and low-melting-point toner minimizes power requirements and helps achieve low energy consumption.
- Encourage environmentally-conscious work practices by enabling multiple settings that can help save paper and energy.
- ENERGY STAR® certified and rated EPEAT® Gold.⁴

CONFIGURATION OPTIONS

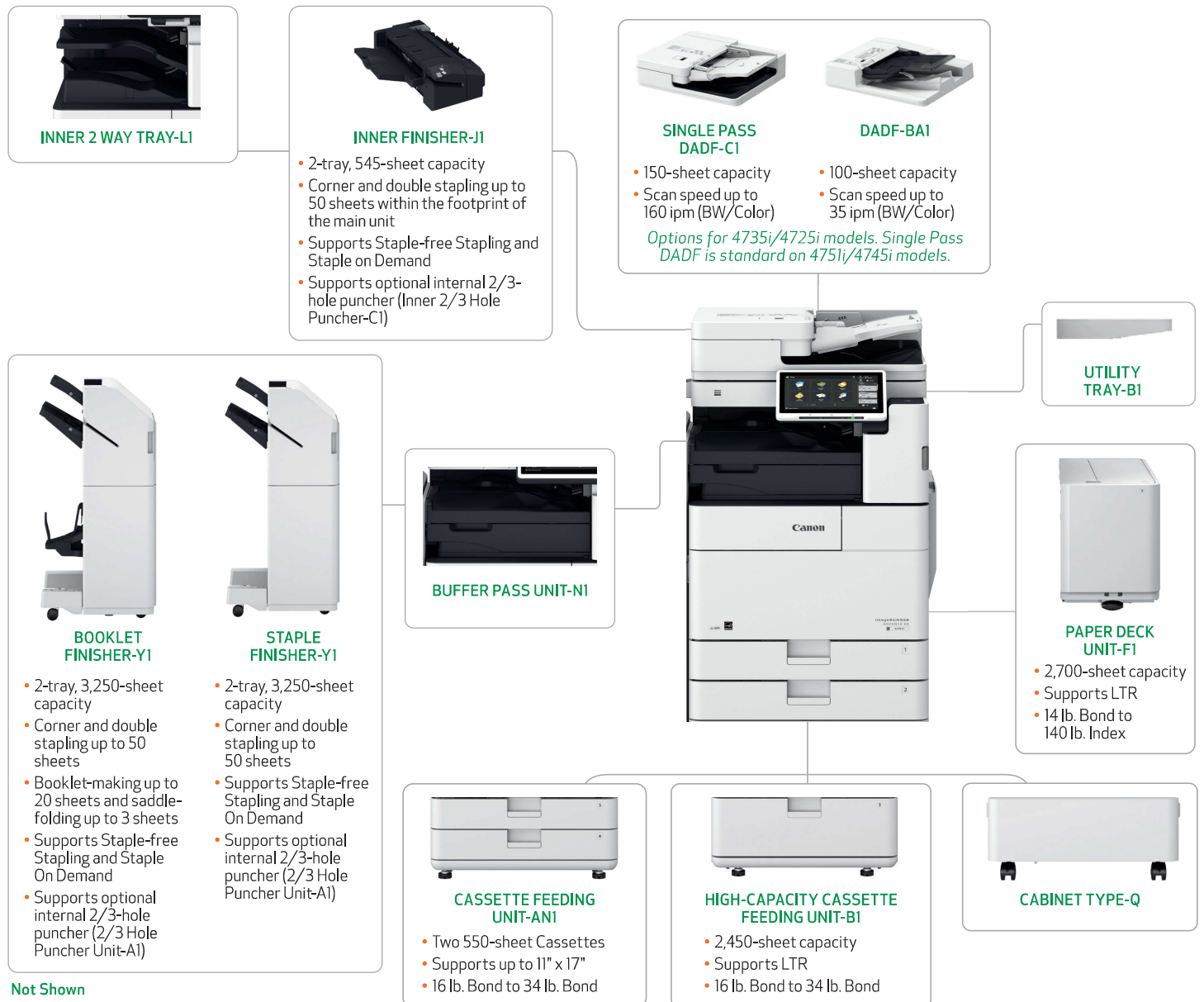

Not Shown

- Inner 2/3 Hole Puncher-C1 (for Inner Finisher-J1)
- 2/3 Hole Puncher Unit-A1 (for External Finishers)
- Platen Cover Type-W

SPECIFICATIONS

Main Unit

Type

Monochrome Laser Multifunctional

Core Functions

Standard: Print, Copy, Scan, Send, Store
Optional: Fax

Processor

1.75 GHz Dual Core Processor

Control Panel

10.1" TFT LCD WSVGA Color Touch-panel

Memory

3.0 GB RAM

Hard Disk Drive

Standard: 250 GB
Maximum: 1 TB

Print Resolution

1200 dpi x 1200 dpi

Interface Connection

Network

Standard: 1000Base-T/100Base-TX/10Base-T,
Wireless LAN (IEEE 802.11 b/g/n)

Optional: NFC, Bluetooth Low Energy

Others

Standard: USB 2.0 x1 (Host), USB 3.0 x1 (Host),
USB 2.0 x1 (Device)

Optional: Copy Control Interface

Paper Capacity (LTR, 20 lb. Bond)

Standard: 1,200 Sheets
Maximum: 6,350 Sheets

Paper Sources (LTR, 20 lb. Bond)

Standard: Two 550-sheet Paper Cassettes,
100-sheet Stack Bypass

Optional: Two 550-sheet Paper Cassettes (Cassette
Feeding Unit-ANI), 2,450-sheet Paper Deck
(High Capacity Cassette Feeding Unit-B1),
2,700-sheet Paper Deck (Paper Deck
Unit-F1)

Paper Output Capacity (LTR, 20 lb. Bond)

Standard: 250 Sheets
3,350 Sheets (with Buffer Pass-N1 + Staple)

Maximum: Finisher-Y1 or Booklet Finisher-Y1

Finishing Capabilities

Standard: Collate, Group
With Finishers: Collate, Group, Offset, Staple, Saddle Stitch,
Hole Punch, Eco Staple, Staple On Demand

Supported Media Types

Upper/Lower Casette: Thin, Plain, Recycled, Color, Heavy,
Pre-punched
Multi-purpose Tray: Thin, Plain, Recycled, Color, Heavy,
Pre-punched, Bond, Transparency,
Label, Envelope

Supported Media Sizes

Upper Cassette: Legal, Letter, Letter-R, Executive,
Statement-R, Custom Size
(5-1/2" x 7-1/8" to 11-3/4" x 15-3/8")
Lower Cassette: 11" x 17", Legal, Letter, Letter-R, Executive,
Statement-R, Custom Size
(5-1/2" x 7-1/8" to 11-3/4" x 17"), Envelope⁵:
[No.10 (COM10), Monarch, DL, ISO-C5]
Multi-purpose Tray: 11" x 17", Legal, Letter, Letter-R, Executive,
Statement-R, Envelope [No.10 (COM10),
Monarch, DL, ISO-C5], Custom Size/Free
Size (3-7/8" x 5-7/8" to 11-3/4" x 17")

Supported Media Weights

Upper/Lower Cassette: 16 lb. Bond to 80 lb. Cover (60 to 220 g/m²)
Multi-purpose Tray: 14 lb. Bond to 80 lb. Cover (52 to 220 g/m²)
Duplexing: 16 lb. Bond to 28 lb. Bond (60 to 105 g/m²)

Print/Copy Speed

4751i: Up to 51 ppm (Letter), Up to 37 ppm
(Letter-R), Up to 25 ppm (Legal),
Up to 25 ppm (11" x 17")
4745i: Up to 45 ppm (Letter), Up to 32 ppm
(Letter-R), Up to 25 ppm (Legal),
Up to 22 ppm (11" x 17")
4735i: Up to 35 ppm (Letter), Up to 32 ppm
(Letter-R), Up to 25 ppm (Legal),
Up to 22 ppm (11" x 17")
4725i: Up to 25 ppm (Letter), Up to 17 ppm
(Letter-R), Up to 13 ppm (Legal),
Up to 15 ppm (11" x 17")

Warm-up Time

From Power On: Approx. 24 Seconds⁶
From Sleep Mode: Approx. 10 Seconds⁷
Quick Startup Mode: Approx. 4 Seconds⁸

Dimensions (W x D x H)

4751i/4745i: 24" x 28-1/2" x 36-3/4"
(608 mm x 722 mm x 932 mm)⁹
4735i/4725i: With Platen Cover-Y2: 24" x 28-1/8" x 32-3/8"
(608 mm x 713 mm x 822 mm)
With Single Pass DADF-C1: 24" x 28-1/2" x
36-3/4" (608 mm x 722 mm x 932 mm)
With DADF-BA1: 24" x 28-3/8" x 36-1/2"
(608 mm x 719 mm x 926 mm)

Installation Space (W x D)

Basic: 44" x 45-5/8" (1,116 x 1,160 mm) (with Platen
Cover-Y2 + Multi-purpose Tray open/extension
tray extended + Paper Cassette open)
44" x 46" (1,116 x 1,169 mm) (with Single
Pass DADF-C1 + Multi-purpose Tray open/
extension tray extended + Paper Cassette
open)
44" x 45-7/8" (1,116 x 1,166 mm) (with DADF-
BA1 + Multi-purpose tray open/extension
tray extended + Paper Cassette open)
71-3/8" x 46" (1,811 x 1,169 mm) (with Single
Pass DADF-C1 + Paper Deck Unit-F1 + Booklet
Finisher-Y1 with extension tray extended and
Saddle unit drawn)
71-3/8" x 45-7/8" (1,811 x 1,166 mm) (with
DADF-BA1 + Paper Deck Unit F1 + Booklet
Finisher-Y1 with extension tray extended and
Saddle unit drawn)

Weight¹⁰

4751i/4745i: Approx. 193.8 lb. (87.9 kg)
With Platen Cover: Approx. 165.3 lb. (75 kg)
With Single Pass DADF-I: Approx. 193.8 lb.
(87.9 kg)
4735i/4725i: With DADF-BA1: Approx. 179.5 lb

Print Specifications

Standard Page Description Languages

UFR II, PCL[®]6, Adobe[®] PS[®] 3

Supported File Types for Direct Print

PDF, TIFF, JPEG, EPS, XPS

Printing from Mobile Devices and Cloud-based Services

A range of standard and optional software and MEAP-based solutions (including AirPrint, Mopria, Google Cloud Print, Canon PRINT Business, and uniFLOW Online) are available to provide printing from mobile devices or internet-connected devices and cloud-based services depending on your requirements. Please contact your sales representative for further information.

Fonts

PCL Fonts: 93 Roman, 10 Bitmap fonts, 2 OCR fonts,
Andalé Mono WT J/K/S/T (Japanese,
Korean, Simplified and Traditional Chinese),¹¹
Barcode Fonts¹²
PS Fonts: 136 Roman

Operating System¹³

UFR II/PS: Windows[®] 7/8.1/10/Server 2008/Server
2008 R2/Server 2012/Server 2012 R2/
Server 2016/Server 2019, Mac OS X (10.10
or later)
PCL: Windows[®] 7/8.1/10/Server 2008/Server
2008 R2/Server 2012/Server 2012 R2/
Server 2016/Server 2019
PPD: Windows[®] 7/8.1/10, Mac OS X (10.9 or later)

Copy Specifications

First-Copy-Out Time (Letter)

4751i: As fast as 3.7 seconds
4745i: As fast as 3.8 seconds
4735i: As fast as 3.8 seconds
4725i: As fast as 5.2 seconds

Copy Resolution (dpi)

600 x 600

Multiple Copies

Up to 9,999 Copies

Copy Exposure

Automatic or Manual (9 Levels)

Magnification

25%-400% (1% Increments)

Preset Reduction/Enlargement

25%, 50%, 64%, 73%, 78%, 100%(1:1), 121%, 129%,
200%, 400%

Scan Specifications

Type

4751i/4745i: Standard Single Pass Duplexing Automatic
Document Feeder
4735i/4725i: Optional Single Pass Duplexing Automatic
Document Feeder, Duplexing Automatic
Document Feeder, or Platen Cover

Document Feeder Paper Capacity

Single Pass DADF: Up to 200 Sheets
DADF: Up to 100 Sheets

Document Feeder Supported Media Sizes

11" x 17", Legal, Letter, Letter-R, Statement, Statement-R

Document Feeder Supported Media Weights

Single Pass DADF-C1
Single-sided Scanning: 13.3 lb. Bond to 80 lb. Cover
(50 to 220 g/m²)
Double-sided Scanning: 13.3 lb. Bond to 80 lb. Cover (50 to 220 g/m²)
DADF-BA1
Single-sided Scanning: 13.3 lb. Bond to 34 lb. Bond (50 to 128 g/m²)
(BW), 17 lb. Bond to 34 lb. Bond (64 to 128
g/m²) (CL)
Double-sided Scanning: 13.3 lb. Bond to 34 lb. Bond (50 to 128 g/m²)
(BW), 17 lb. Bond to 34 lb. Bond (64 to 128
g/m²) (CL)

Platen Acceptable Originals

Sheet, Book, 3-Dimensional Objects

Platen Supported Media Size

UP to 11-3/4" x 17" (297 mm x 431.8 mm)

Pull Scan

Color Network ScanGear2 for both Twain and WIA
Supported OS: Windows[®] 7/8.1/10/Server 2008/Server 2008
R2/Server 2012/Server 2012 R2/Server 2016

Scan Resolution (dpi)

Push: Up to 600 x 600
Pull: Up to 600 x 600

Scan to Mobile Devices and Cloud-based Services

A range of solutions is available to provide scanning to mobile devices and cloud-based services depending on your requirements.

Scan Speed (Letter)

Single Pass DADF-C1
Single-sided Scanning
BW/Color: 135/135 (300 x 300 dpi, send)
80/80 (600 x 600 dpi, copy)
Double-sided Scanning
BW/Color: 270/270 (300 x 300 dpi, send)
60/90 (600 x 600 dpi, copy)

DADF-BA1

Single-sided Scanning
BW/Color: 70/70 (300 x 300 dpi, send)
51/51 (600 x 600 dpi, copy)
Double-sided Scanning
BW/Color: 35/35 (300 x 300 dpi, send)
25.5/25.5 (600 x 600 dpi, copy)

Send Specifications

Destination

Standard: E-mail/Internet FAX (SMTP), SMB 3.0, FTP, WebDAV, Mail Box
Optional: Super G3 Fax, IP Fax

Address Book

LDAP (2,000)/Local (1,600)/Speed dial (200)

Send Resolution (dpi)

Push: Up to 600 x 600
Pull: Up to 600 x 600

Communication Protocol

File: FTP (TCP/IP), SMB 3.0 (TCP/IP), WebDAV
Email: SMTP, POP3

File Format

TIFF, JPEG, PDF (Compact, Searchable, Apply Policy, Optimize for Web, PDF/A-1b, Trace & Smooth, Encrypted, Device Signature, User Signature), XPS (Compact, Searchable, Device Signature, User Signature), Office Open XML (PowerPoint, Word)

Fax Specifications (Optional)

Maximum Number of Connection Lines

4

Modem Speed

Super G3: 33.6 Kbps
G3: 14.4 Kbps

Compression Method

MH, MR, MMR, JBIG

Resolution (dpi)

400 x 400, 200 x 400, 200 x 200, 200 x 100

Sending/Recording Size

Statement-R to 11" x 17"

Fax Memory

Up to 30,000 Pages (2,000 Jobs)

Speed Dials

Max. 200

Group Dials/Destinations

Max. 199 Dials

Sequential Broadcast

Max. 256 Addresses

Memory Backup

Yes

Store Specifications

Mail Box (Number Supported)

100 User In-boxes, 1 Memory RX In-box, 50 Confidential Fax In-boxes, 30,000 Maximum Pages Stored (2,000 Jobs Stored)

Advanced Box

Communication Protocol: SMB or WebDAV Supported
Client PC: Windows (Windows 8.1/10)
Concurrent Connections (Max.):
SMB: 64
WebDAV: 3 (Active Sessions)

Advanced Box Available Disk Space

Approx. 16 GB (Standard HDD)
Approx. 480 GB (With Optional 1 TB HDD)

Memory Media

Standard: USB

Security Specifications

Authentication

Standard: Universal Login Manager, uniFLOW Online Express,¹⁴ User Authentication, Department ID Authentication, Access Management System, Device and Function Level Log-in
Optional: uniFLOW

Data

Standard: Trusted Platform Module (TPM), Hard Disk Password Lock, Hard Disk Drive Erase, Mail Box Password Protection, Hard Disk Drive Encryption (FIPS140-2 Validated), Verify System at Startup, McAfee Embedded Control¹⁵
Optional: Hard Disk Drive Mirroring, IEEE 2600.2 Common Criteria Certification, Data Loss Prevention (Requires uniFLOW)

Network

Standard: Encrypted Secure Print, IP/Mac Address Filtering, IPsec, TLS Encrypted Communication (v1.0/1.1/1.2/1.3), SNMP V3.0, IEEE 802.1X, IPv6, SMTP Authentication, POP Authentication before SMTP, S/MIME, SIEM Integration

Document

Standard: Secure Watermark, Secure Print, Forced Hold Printing, Adobe LiveCycle[®] Rights Management ES2.5 Integration, Encrypted PDF, Encrypted Secure Print, Device Signature, User Signature

Environmental Specifications

Operating Environment

Temperature: 50 to 86°F
Humidity: 20 to 80% RH (Relative Humidity)

Power Requirements

110-127V, 60Hz, 10.4A

Power Consumption

Maximum: Approx. 1,500 W
Standby: Approx. 39 W¹⁵
Sleep Mode: Approx. 0.9 W¹⁶
Typical Electricity Consumption (TEC) Rating¹⁷
4751i: 0.71 kWh
4745i: 0.62 kWh
4735i: 0.51 kWh
4725i: 0.34 kWh

Standards

ENERGY STAR[®] Certified
Rated EPEAT[®] Gold⁴

Consumables

Toner

GPR-57 Toner BK

Toner Yield (Estimated @ 6% Coverage)

Black: 42,100 Images

- ¹ Subscription to a third-party cloud service required. Subject to third-party cloud service provider's terms and conditions.
- ² Requires Unified Firmware Platform v3.9 or greater.
- ³ Requires additional option.
- ⁴ For current EPEAT rating (Gold/Silver/Bronze), please visit www.epeat.net.
- ⁵ Envelope Feeder Attachment-D1 is required.
- ⁶ Time from device power-on, until copy ready (not print reservation).
- ⁷ Time from exiting Sleep mode to when printing is operational.
- ⁸ Time from device power on to when the copy icon appears and is enabled to operate on the touch panel display.
- ⁹ Time from device power-on to when key orientations can be performed on the touch panel display.
- ¹⁰ Includes toner.
- ¹¹ Requires the optional PCL International Font Set-A1.
- ¹² Requires the optional Barcode Printer Kit-D1.
- ¹³ Other operating systems and environments including AS/400, UNIX, Linux and Citrix may be supported. Some of these solutions are chargeable. SAP Device Types are available via the SAP Market Place. For more information, contact your sales representative.
- ¹⁴ No charge for this solution; however activation is required.
- ¹⁵ Reference Value (measured one unit).
- ¹⁶ 0.9 W sleep mode not available in all circumstances due to certain settings.
- ¹⁷ Based on ENERGY STAR Product Specification for Imaging Equipment Version 3.0.

USA.CANON.COM/SIMPLYADVANCED



AirPrint and the AirPrint logo are trademarks of Apple Inc. Canon, imageRUNNER, imageWARE, imagePASS, and the GENUINE logo are registered trademarks or trademarks of Canon Inc. in the United States and may also be registered trademarks or trademarks in other countries. Canon products offer certain security features, yet many variables can impact the security of your devices and data. Canon does not warrant that use of its features will prevent security issues. Nothing herein should be construed as legal or regulatory advice concerning applicable laws; customers must have their own qualified counsel determine the feasibility of a solution as it relates to regulatory and statutory compliance. McAfee and the McAfee logo are trademarks of McAfee LLC in the US and/or other countries. All other referenced product names and marks are trademarks of their respective owners. All printer output images are simulated. All features presented in this brochure may not apply to all Series and/or products and may be optional; please check with your Canon Authorized Dealer for details. Products shown with optional accessories. Canon U.S.A. does not provide legal counsel or regulatory compliance consultancy, including without limitation, Sarbanes-Oxley, HIPAA, GLBA, Check 21 or the USA Patriot Act. Each customer must have its own qualified counsel determine the advisability of a particular solution as it relates to regulatory and statutory compliance. Specifications and availability subject to change without notice. Not responsible for typographical errors.
©2020 Canon U.S.A., Inc. All rights reserved.

0320RI-IRA4700DXSR5B-PDF-IH



To learn about Canon's many awards, visit usa.canon.com/awards.